

RAILMOUNTED TERMINAL BLOCKS — TBD10D-XXP

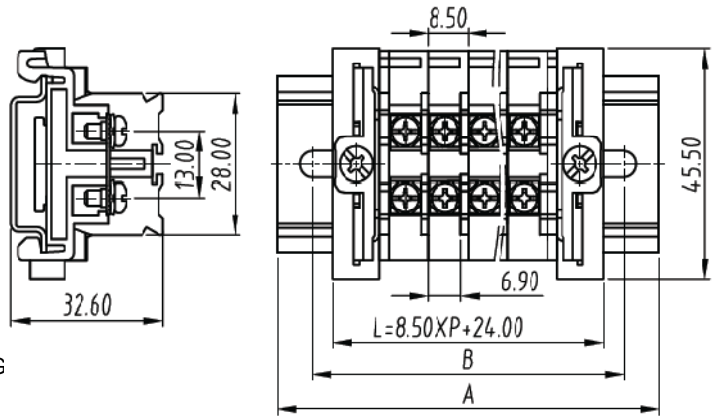

图示(Pic. shown) : TBD10D-XXP-K

General:

- Railmounted terminal Blocks Rated : 300V,10A , 16AWG
- Single row , 8.50mm pitch , 02-12 Pole
- Wiring orientation: 180°(wire-to-wire)
- Screw clamp unit: M3.0, 0.8Nm Max

认证 (Approval) :

| 技术参数 Technical Data | UL standard | | | IEC standard | | |
|--|--------------------------|------|------|--|---------|--------|
| UL应用组别(UL Application group) | UL Application group | | | IEC过电压别/污染等级(IEC overvoltage category /pollution degree) | | |
| IEC过电压别/污染等级(IEC overvoltage category /pollution degree) | B | C | D | III / 3 | III / 2 | II / 2 |
| 额定电压(Rated voltage) | 300V | 300V | 300V | -- | -- | -- |
| 额定电流(Rated current) | 10A | 10A | 10A | -- | -- | -- |
| 额定连接容量(Rated connection capacity) | 22-16AWG Sol&Str | | | -- | | |
| 绝缘材料(Insulation Material) | PC V2 | | | | | |
| 电流承载部件材料和镀层(Material & Plating of Current carrier) | Copper alloy , Ni plated | | | | | |
| 接线弹片材料(Material of Clamp spring) | -- | | | | | |
| 绝缘电阻(Insulation Resistance) | 500MΩ or more at DC500V | | | | | |
| 耐电压(1分钟)(Withstanding Voltage/1Min) | 2000V | | | | | |
| 额定冲击电压(Rated surge voltage) | -- | | | | | |
| 接线螺丝(Wire clamp unit Screw) , 最大扭矩(torque Max.) | M3.0, 0.8Nm Max | | | | | |
| 固定螺丝(Mounting Screw) , 扭矩(torque) | -- | | | | | |
| 剥线长度(Wire stripping length) | -- | | | | | |
| 使用温度(Operating temperature) | -40°C up to +125°C | | | | | |
| 焊接方式(Soldering recommend) | -- | | | | | |

订购方式(How to order)

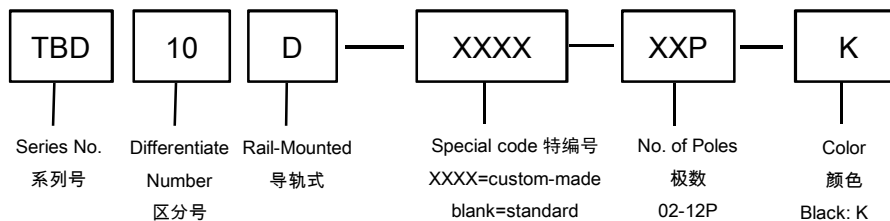

Web:www.china-tianli.com TEL:+86-574-6347-9600,6389-6436 Mail : sale@china-tianli.cn
 地址:中国浙江省宁波杭州湾新区庵东工业园区纬三路138号
 ADD : 138 , Weisan Rd.,Andong Development Zone, Hangzhou Bay Area, Ningbo, Zhejiang, China